



www.mhmukltd.com

Introducing the :
MHM - JOVISA JS1000
 Fully Automatic Horizontal Baler

This fully automatic horizontal baler model is capable of processing card, paper, plastics and RDF materials without preconditioning such as straw, lucerne, etc. and fodder in general. The main characteristic of this machine is the tying system which can be vertical or horizontal and with press pressure 45 to 85 tonne and bale weights of 500kg. A cord baling system can also be supplied with this machine to suit your individual needs. With production up to 11 tonne per hour and the fantastic reliability this horizontal baler offers you can expect bale after bale 24/7.



Description	Units	JS-1000VL/45	JS-1000VL/60	JS-1000VL/75	JS-1000/Contenedor
Force of pressing	Tn	45	60	75	75
Force of pressing	kW	22	36.8	44.1	44.1
No Hydraulic pumps/type	-----	1/Variable Flow	1/Variable flow	1/Variable flow	1/Variable flow
Section of bale	mm	800x1000	800x1000	800x1000	720x1000
Section of hopper	mm	1600x1000	1600x1000	1600x1000	1600x1000
Volume of theoretical baling	m3/h	133	153	156	144
Theoretical Production According Calculations with density 500Kg/m3	Tn/h	6.6	7.6	7.8	7.2
Position of tying device	-----	Lateral/Vertical	Lateral/Vertical	Lateral/Vertical	Vertical

Photographs for illustration purposes only

CE Marked

MHM UK LTD

Unit C Royalty Ln, Swineshead, Boston PE20 3PJ
 Tel : +44 (0)1205 821522 Fax: +44 (0)1205 821554
 Email: sales@mhmukltd.com

MHM are sole distributors for sales & service for all Jovisa, S.L machines to the whole of the UK & Ireland



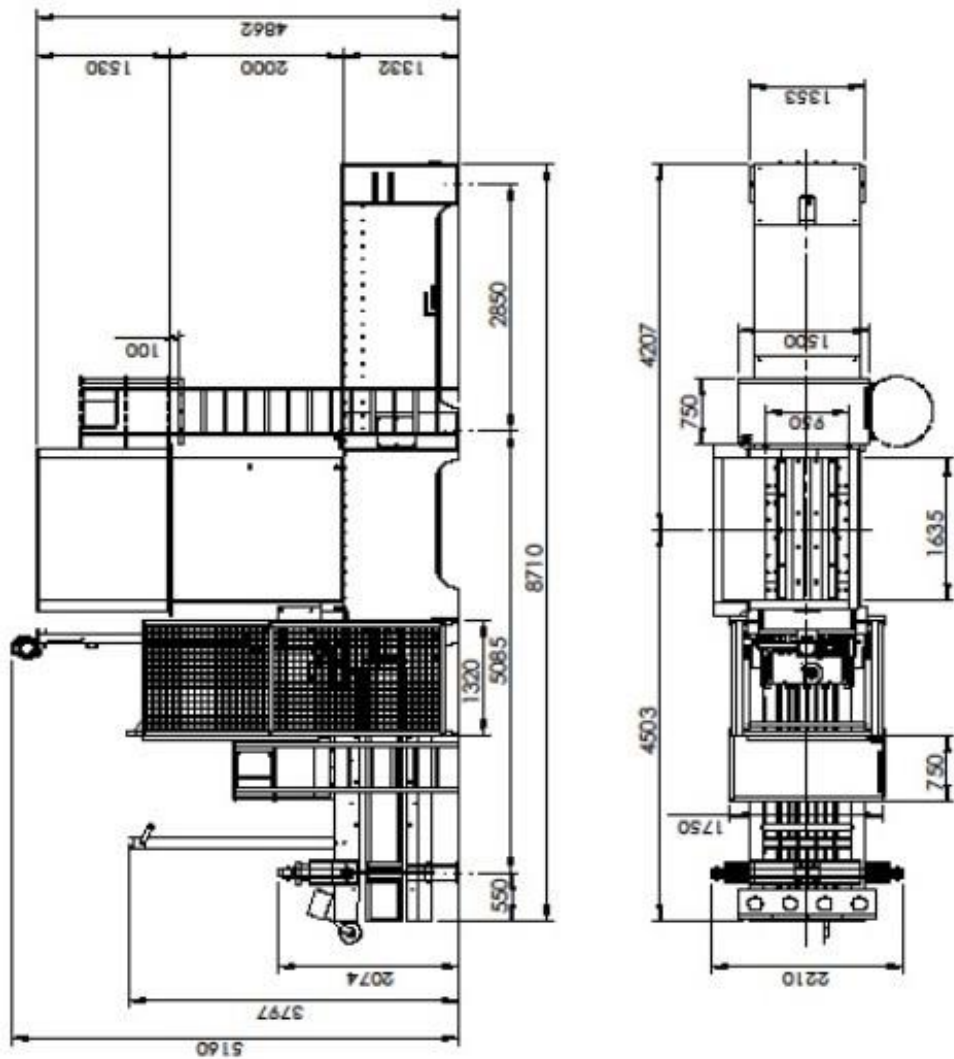
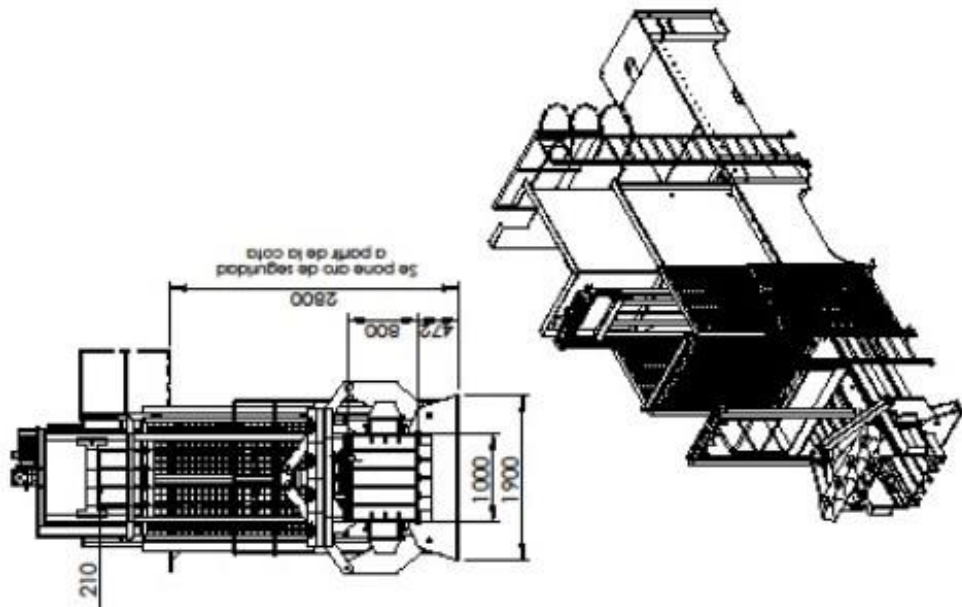

Photographs for illustration purposes only

MHM UK LTD
 Fenhouses Drove, Swineshead, Boston, Lincolnshire, PE20 3HE
 Tel : +44 (0)1205 821522 Fax: +44 (0)1205 821554
 Email: sales@mhmutd.com

CE Marked

MAQUINARIA E HIDRÁULICA
JOVISA, S.L.

MHM are sole distributors for sales & service for all Jovisa, S.L machines to the whole of the UK & Ireland

