



## Introducing the:

### MHM HD205 Drum Crusher

This powerful unit will crush 45 gallon / 205 litre steel drums at a ratio of 6—8 into 1, greatly reducing disposal costs and storage space. The drum crusher has a totally enclosed shell for high levels of safety and a 30 litre "oil collection tray" with tap connection to prevent any spillage or leakage of residual liquids.

- Reduce drum disposal costs
- High compaction force ratio
- Totally enclosed chamber insures high level of safety
- 30 litre oil collection tray with tap

Height: 2.587m

Width: 1.190m

Depth: 1.000m

Weight: 690kg

#### Loading Aperture Sizes

Height: 1.202m

Depth: 0.816m

Width: 0.823m

Transportation Height: 1.800m

Power supply: 380-400 Volt 3 phase

Motor: 11kW 32 amp

Pressing force: up to 24 Ton

Noise level: 74 decibels

Compaction ratio: 6:1



MHM are sole distributors for sales and service  
for all Jovisa, S.L machines to the whole of the  
UK & Ireland

MHM UK LTD



**JOVISA, S.L.**  
MAQUINARIA E HIDRÁULICA

MHM UK LTD

Fenhouse Drove, Swineshead, Lincolnshire, PE20 3HE  
Tel: +44 (0)1205 821522 Email: sales@mhmukltd.com

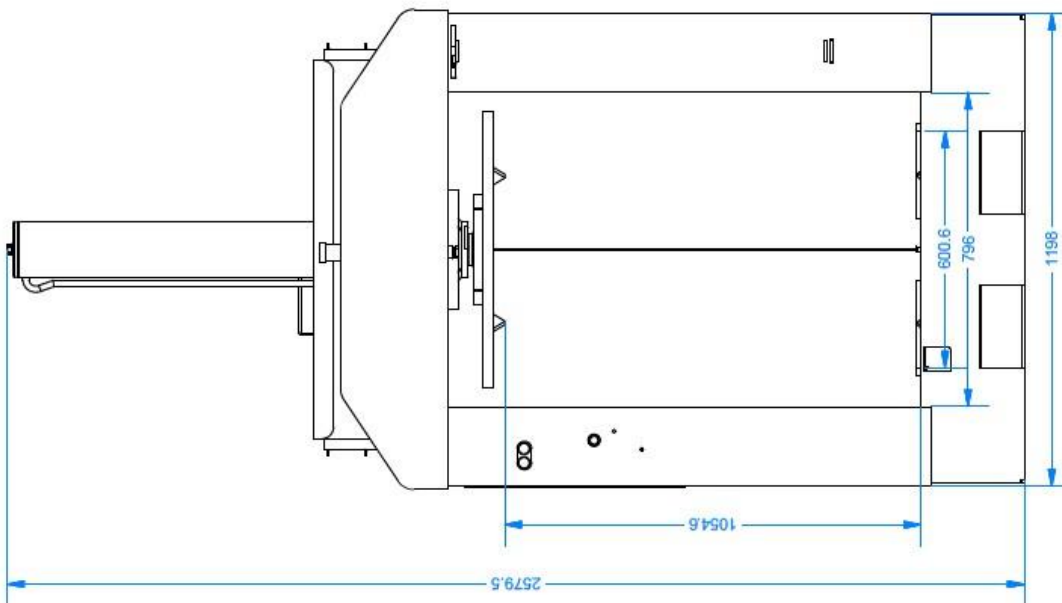
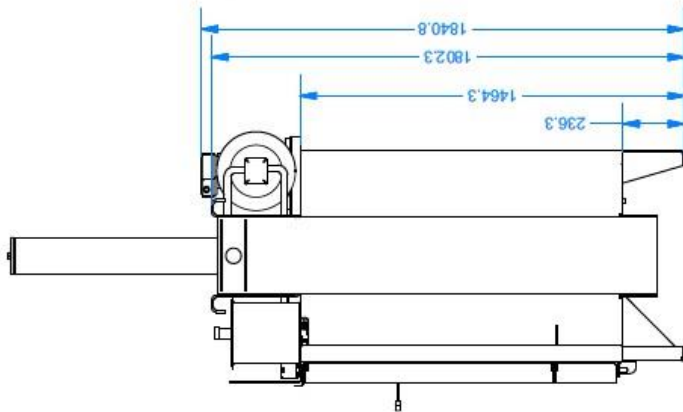
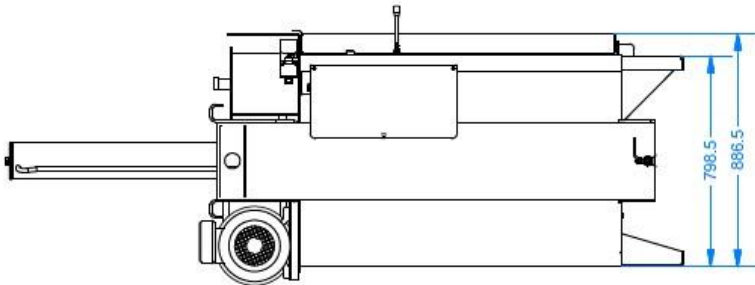
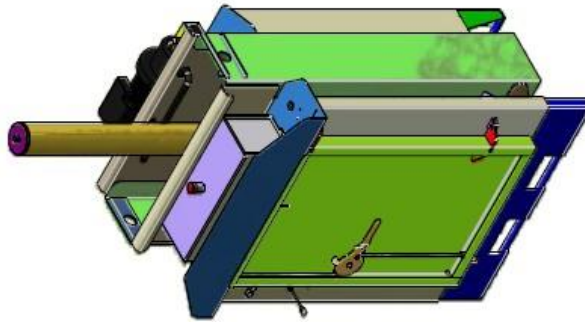

MHM are sole distributors for sales and service  
for all Jovisa, S.L machines to the whole of the  
UK & Ireland

MHM UK LTD



**JOVISA, S.L.**  
MAQUINARIA E HIDRÁULICA

MHM UK LTD

Fenhouse Drove, Swineshead, Lincolnshire, PE20 3HE  
Tel: +44 (0)1205 821522 Email: sales@mhmukltd.com